



# Technical Data

# MetroSeries™ High Pressure Laminate Partitions and Screens

# 1550 SERIES

### SPECIFICATION

**Height:** 58" (1473mm) Doors and Panels with 12" (305mm) Floor Clearance

### MATERIAL

**Stiles\*** — 1" (25mm) finished thickness: 3-ply, 45-lb (20.4-kg) density, resin-impregnated particle board; surfaces and edges are .050" (1.3mm) thick, high-pressure plastic laminate with colored face sheets and matte finish.

#### Standard Size Stiles:

- For compartments — 3", 4", 5", 6", 7", 8", 10", 12", 16", 18", 20", or 24" (76, 102, 127, 152, 179, 203, 254, 305, 406, 457, 508, 610mm) wide.
- For screens — 6" (152mm) wide.
- Floor-anchored — 69" (1753mm) high.
- Overhead-braced — 83" (2108mm) high.
- Ceiling-hung — 83" (2108mm) high for 96" (2438mm) ceilings or as required up to 120" (3048mm) ceilings.

**Panels** — 1" (25mm) finished thickness: 3-ply, 45-lb (20.4-kg) density, resin-impregnated particle board; surfaces and edges are .050" (1.3mm) thick, high-pressure plastic laminate with colored face sheets and matte finish.

#### Standard Size Panels:

- For compartments — Up to 84" (2134mm) wide; 58"(1473mm) high.

**Urinal Screens** —1" (25mm) finished thickness: 3-ply, 45-lb (20.4-kg) density, resin-impregnated particle board; surfaces and edges are .050" (1.3mm) thick, high-pressure plastic laminate with colored face sheets and matte finish.

#### Standard Size Urinal Screens:

- For wall-hung screens — Up to 24" (610mm) wide; 42" to 54" (1067 to 1372mm) high.
- For ceiling-hung and floor anchored screens — Up to 60" (1524mm) wide; 58" (1473mm) high.

**Doors** — 1" (25mm) finished thickness: 3-ply, 45-lb (20.4-kg) density, resin-impregnated particle board; surfaces and edges are .050" (1.3mm) thick, high-pressure plastic laminate with colored face sheets and matte finish.

#### Standard Size Doors:

- Inswing and outswing doors are standard 22" to 37" (559 to 940mm) wide; 58" (1473mm) high.

**Headrail (1552 Series Only)** — Extruded anodized aluminum. Enclosed construction with vandal-resistant sloping top.

**Shoe** — 18-8, Type-304, 22-gauge (0.8mm) stainless steel with satin finish; 4" (102mm) high.

**Wall Posts** — 1" by 1 1/2" (25 by 38mm) wide tubing; 18-8, Type-304, 16-gauge (1.6mm) stainless steel with satin-finish. 58" (1473mm) high, pre-drilled for door hardware.

**TOP VIEW OF 1552 (BARREL HINGE AND STANDARD BRACKET) INSTALLATION.**

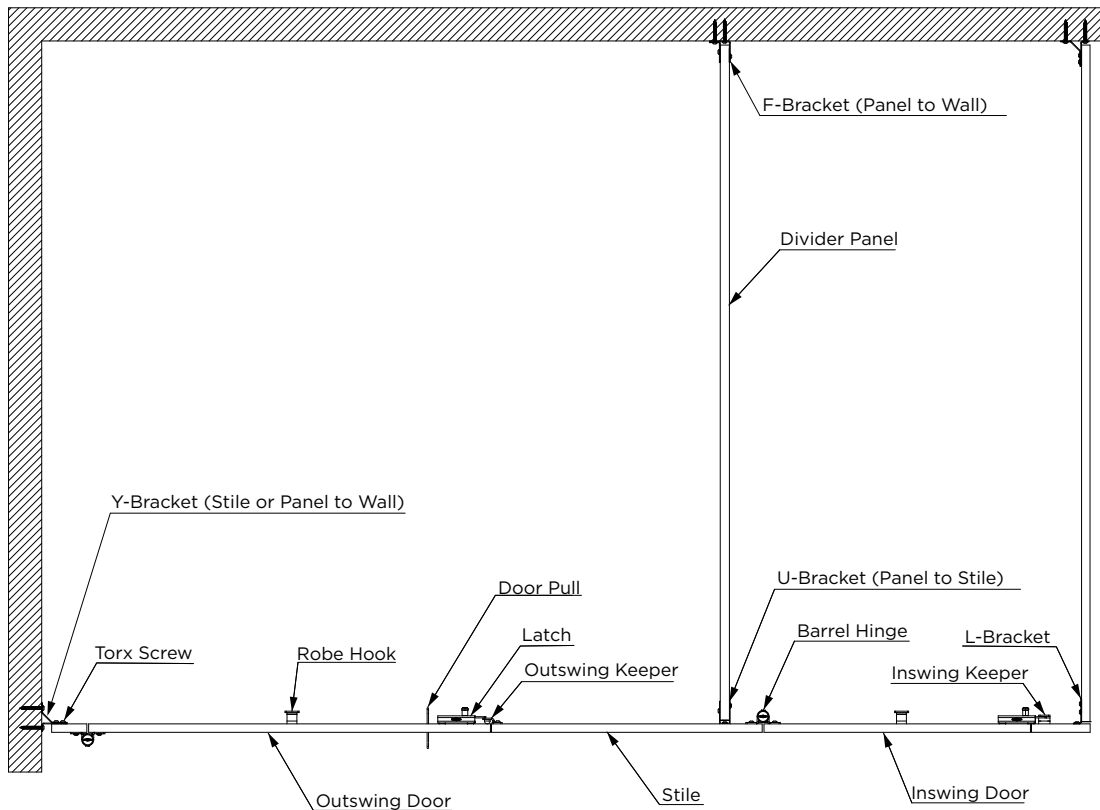

**ANCHORING DEVICE:**

**Leveling Device** — Floor-Anchored or Ceiling-Hung: 3/8" x 1" (10 x 25mm) steel bar, zinc-chromate plated, bolted to stile using 6" x 3/8" (152 x 10mm) diameter carbon steel lag bolt. Furnished with 3/8" (10mm) diameter threaded rods, hex nuts, washers, spacer sleeve(ceiling-hung only), expansion shield and shoe retainer.

**Floor-Anchored Leveling Device Detail**

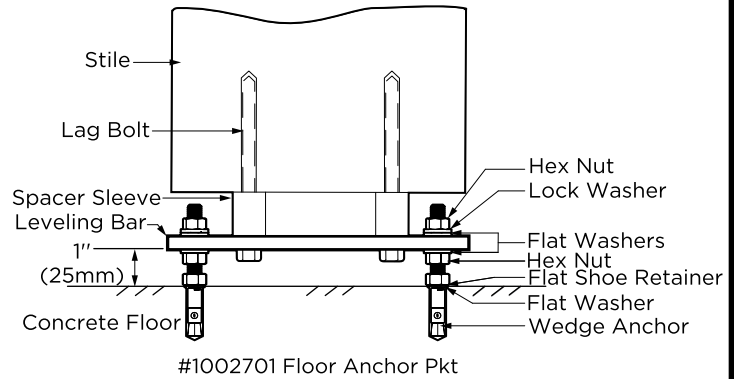

**CEILING LEVELING DEVICE**

Provisions must be in the construction of the building to support ceiling-hung toilet partitions. Structure in ceiling, not furnished by Bobrick, must support at least 295 lb per high pressure laminate toilet compartment, and must be sufficiently rigid to withstand swinging motion of toilet partition doors and impact of doors against stiles. Actual mounting system, including lateral bracing, if required, must be designed by the architect or structural engineer, and furnished by others. Wood beams are not recommended for ceiling hung application.

**Note:** If adequate ceiling support cannot be provided, the floor anchored or overhead-braced toilet compartments are recommended.

**Approximate Weight:** High Pressure Laminate Toilet Compartment - 295lbs.

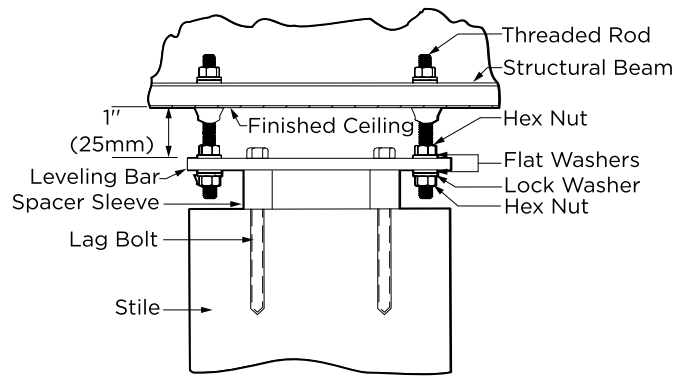

**OVERHEAD-BRACED LEVELING DEVICE**

**Leveling Device** — Overhead-Braced Series: 12-gauge (2.8mm), 3" x 1 1/4" (75 x 32mm) plated steel stile bracket factory installed to bottom of stile. Furnished with leveling bolt, shoe retainer, floor L-bracket, plastic anchor, #14-16, #14 x 5/8" (M6.3 x 16mm) stainless steel sheet-metal screws and #14 x 1 3/4" (M6.3 x 45mm) stainless steel sheet-metal floor screws.

**Overhead-Braced Floor Leveling Device**

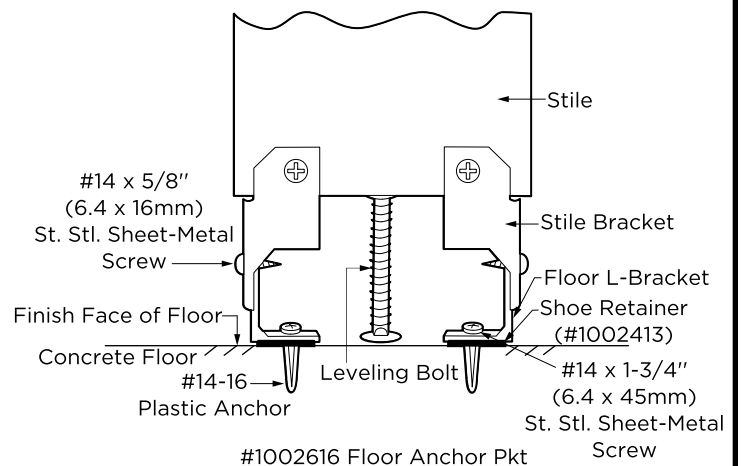
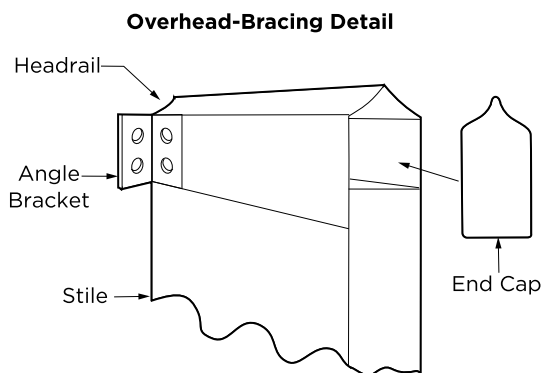

**COMMERCIAL HARDWARE (STANDARD)**

Hinges, door latch, door keepers, clothes hooks, mounting brackets and door handles are constructed of 18-8, Type-304, heavy-gauge stainless steel with satin finish.

Threaded inserts are factory installed for securing hinges. Theft-resistant, stainless steel pin-in-head, torx screws are furnished for door hardware and all mounting brackets.

Balanced hinge is adjustable to hold door of unoccupied toilet compartment partially open or fully closed.

Toilet compartment door is locked from inside by sliding door latch into keeper. A locked compartment may be opened from outside by lifting door to disengage latch from keeper. Track of door latch prevents inswing door from swinging out beyond stile; on outswing door, the door keeper prevents it from swinging in beyond stile. Door handles and latch have operable parts that are operable with one hand and do not require tight grasping, pinching, or twisting of the wrist; and comply with ADA Sections 404.2.7 and 309.4. The force required to activate the operable parts shall be 5 pounds (22.2N) maximum. Black rubber bumper on the latch serves as door bumper for inswing door.

**#1040-42 LATCH ASSEMBLY**

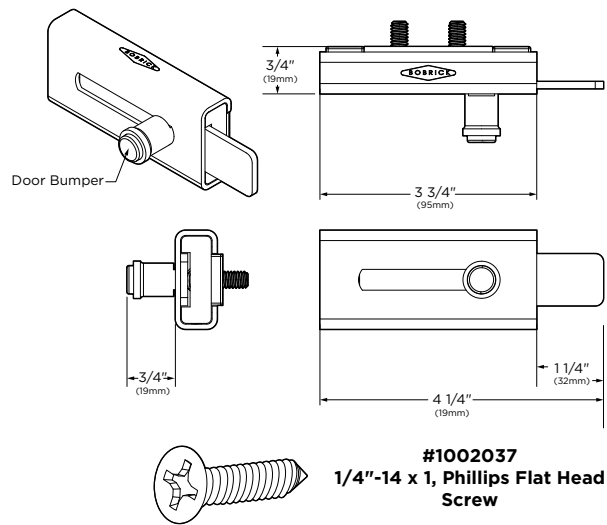

**#1002037**  
1/4"-14 x 1, Phillips Flat Head Screw

**1040-35 KEEPER, INSWING**

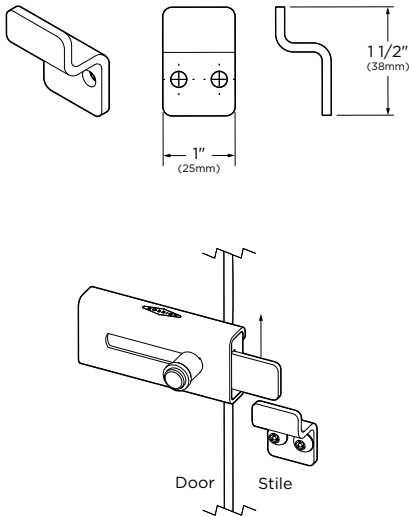

**1040-36 KEEPER, OUTSWING**

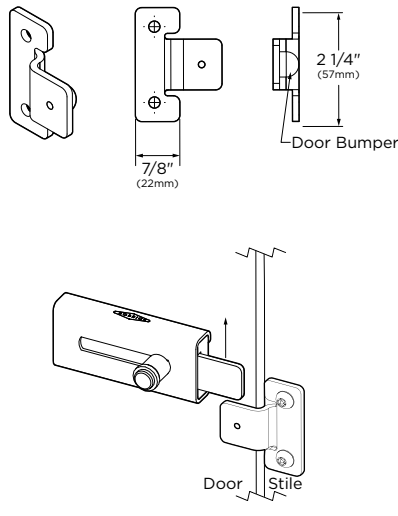

**1040-39 PERPENDICULAR**

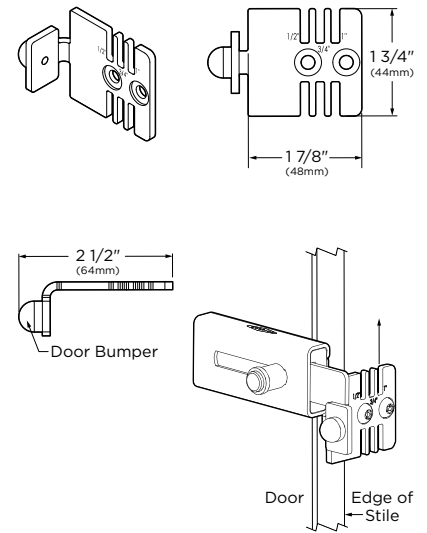

**#1040-56 WALL MOUNTED KEEPER INSWING**

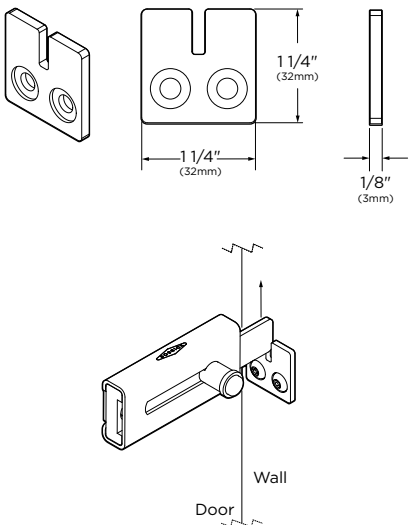

**#1000869 COAT HOOK**

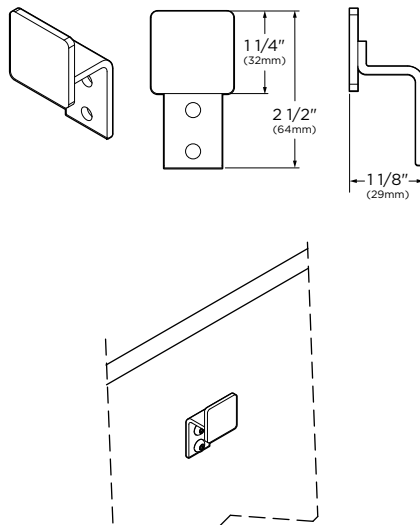

**#1000312 DOOR PULL HANDLE**

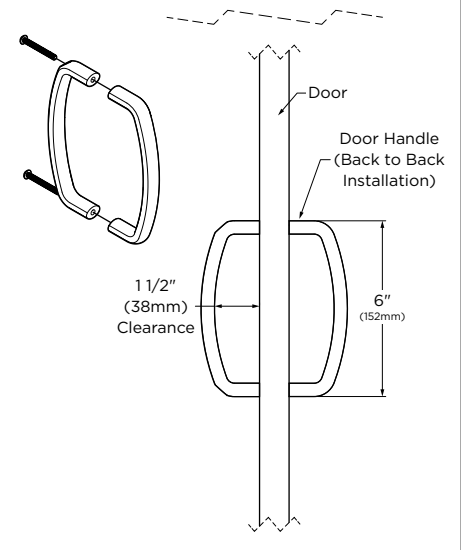

**#1002330  
BARREL HINGE SET, L**

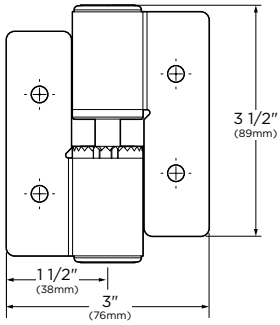

**#1002331  
BARREL HINGE SET, J**

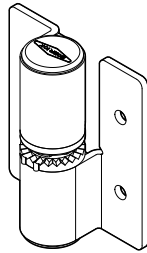
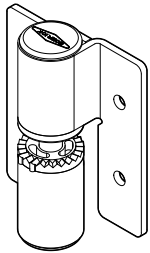
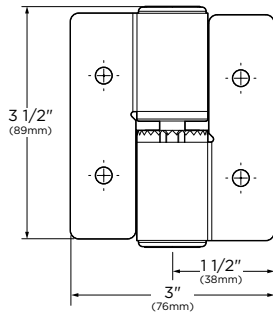

**#1002156  
Hinge Cam**



Hinges are constructed of 18-8, Type-304, heavy-gauge stainless steel with satin finish. Threaded inserts are factory installed for securing hinges. Theft-resistant, stainless steel pin-in-head, torx screws are furnished for door hardware. Balanced hinge is adjustable to hold door of unoccupied toilet compartment partially open or fully closed.

**CAM SETTINGS**

**Door Beyond Closed Position**

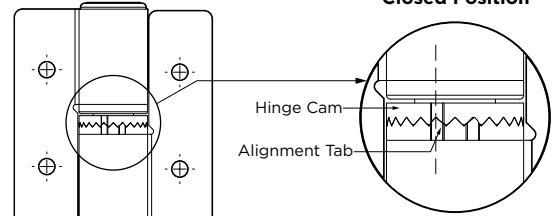

**Door Normal Closed Position**

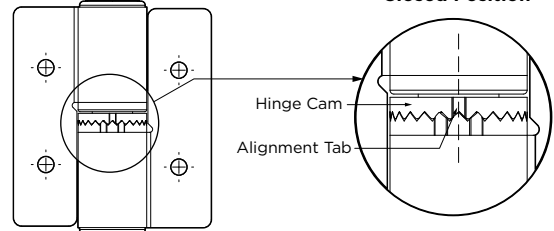

**Door Remain Open 15 Degrees**

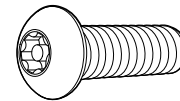
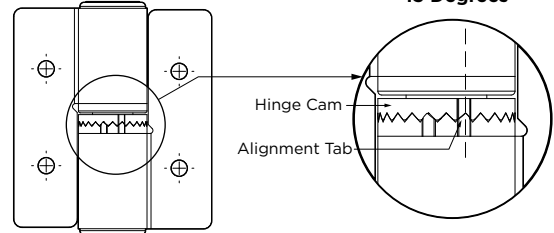

**#1002494  
1/4-20 x 3/4"  
Pin-in-Head Torx Screw**

**BRACKETS (STANDARD):**

**#1000351  
L-Bracket  
(Panel to Corner Stile)**

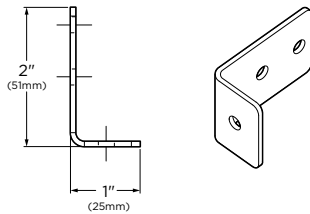

**#1000356  
U-Bracket  
(Panel to Perp. Stile)**

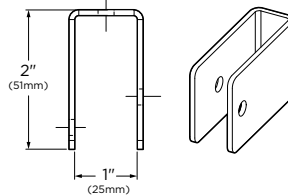

**#1002500  
#12 x 3/4" Pin-in-Head Torx Screw  
Panel/Stile Screw**

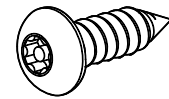

**#1000974  
Y-Bracket  
(Stile to Wall)**

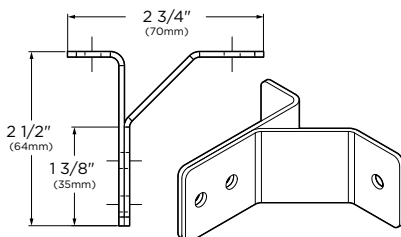

**#1000353  
F-Bracket  
(Panel to Wall)**

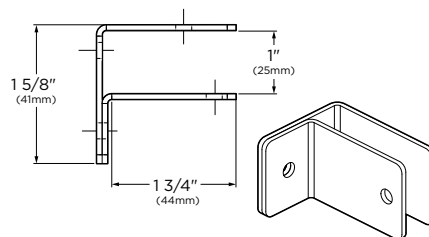

**#1002495  
#12 x 2" Pin-in-Head Torx Screw  
(M5.5 x 50mm) Wall Screw**

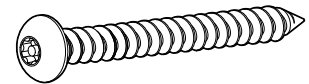

**1551 SERIES FLOOR ANCHORED**

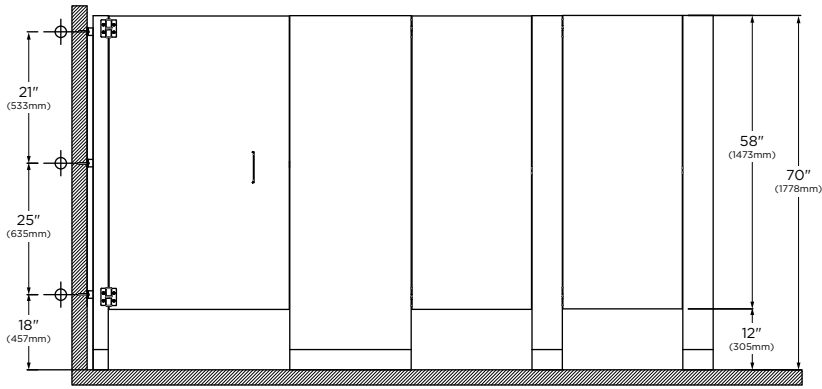

**Front View**

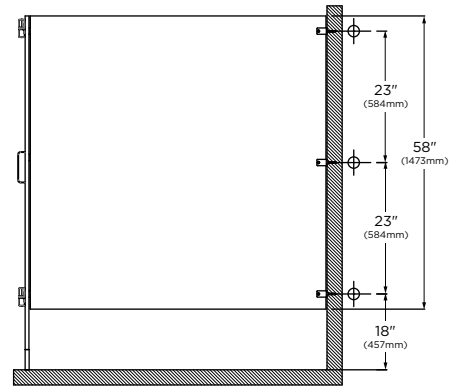

**Side View**

**STANDARD:**

- #1551 - Barrel Hinge and Standard Bracket

**1552 SERIES OVERHEAD-BRACED**

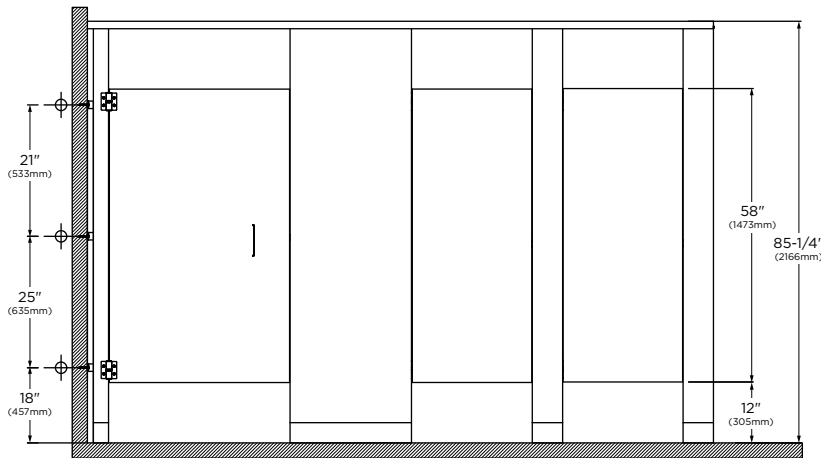

**Front View**

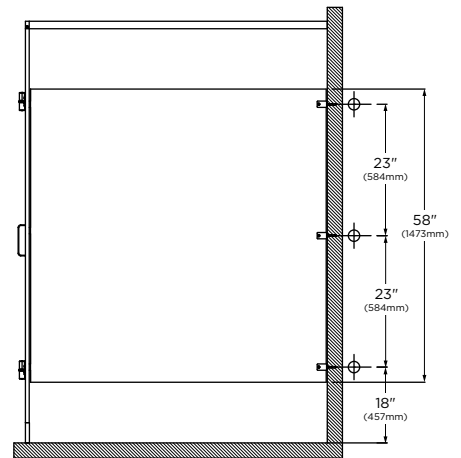

**Side View**

**STANDARD:**

- #1552 - Barrel Hinge and Standard Bracket

**1558 SERIES CEILING HUNG**

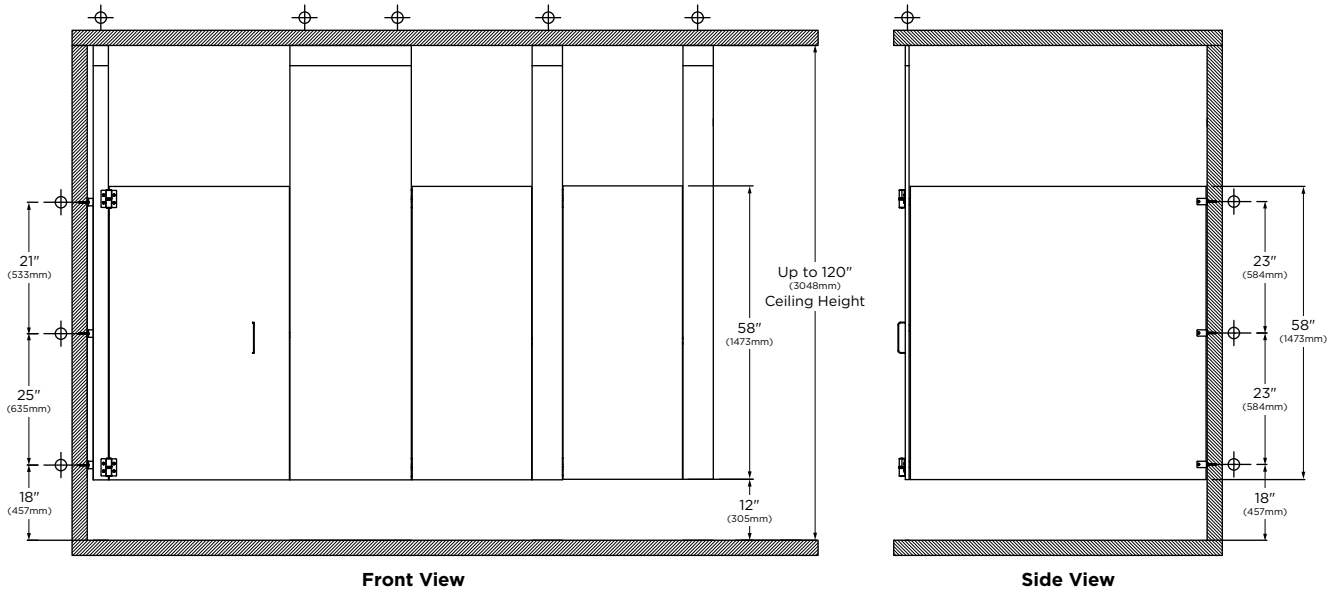

**STANDARD:**

- #1558 - Barrel Hinge and Standard Bracket

**OCCUPANCY INDICATOR LATCH (OPTION):**

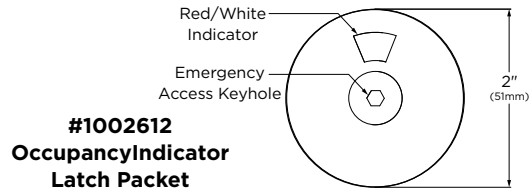

**Emergency Access** - The latch allows the door to be opened from the exterior of the toilet compartment by inserting a 3mm Allen key into the keyhole in the center of the cover plate and turning the key to release the latch.

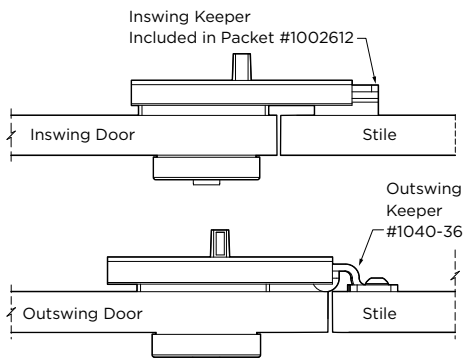

**DOOR STOP (OPTION):**

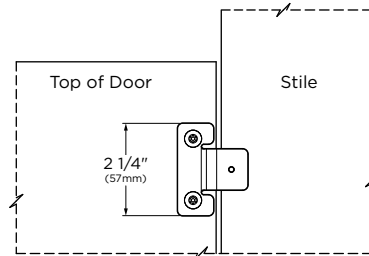
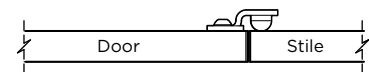
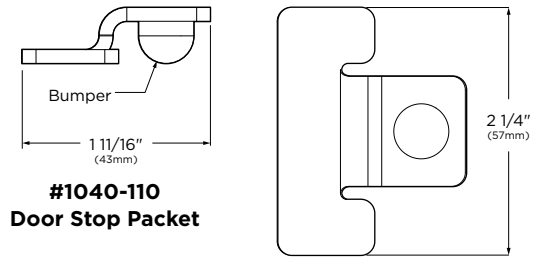

**1550 URINAL SCREENS:**

**#1000357  
W/H Urinal Screen Bracket**

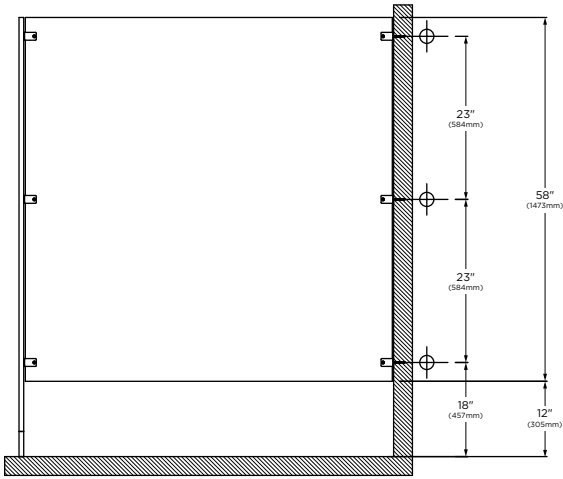

**FLOOR ANCHORED URINAL SCREEN**

**STANDARD:**

- #1551 - Standard Bracket

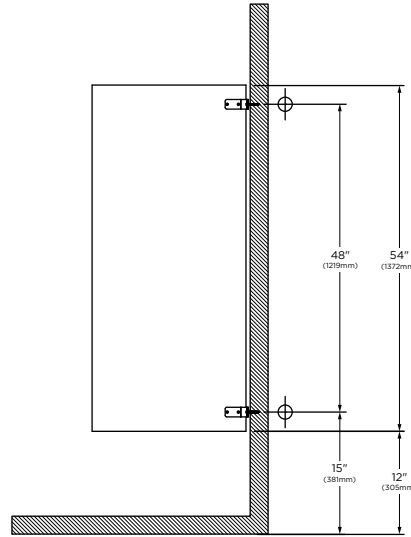

**WALL MOUNTED URINAL SCREEN**

Up to 54" (1372mm) high.

**STANDARD:**

- #1555 - Standard Bracket

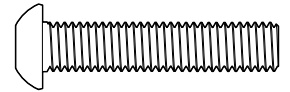
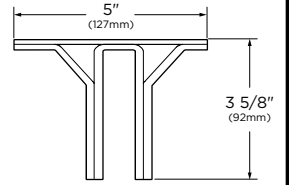
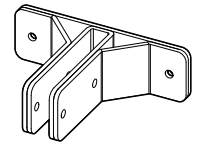

**#1000134  
#10-32 x 1-3/4" (44mm)  
Phillips**



**#1000133  
Acorn Nut #10-32  
Through-Bolt  
Urinal Screen**

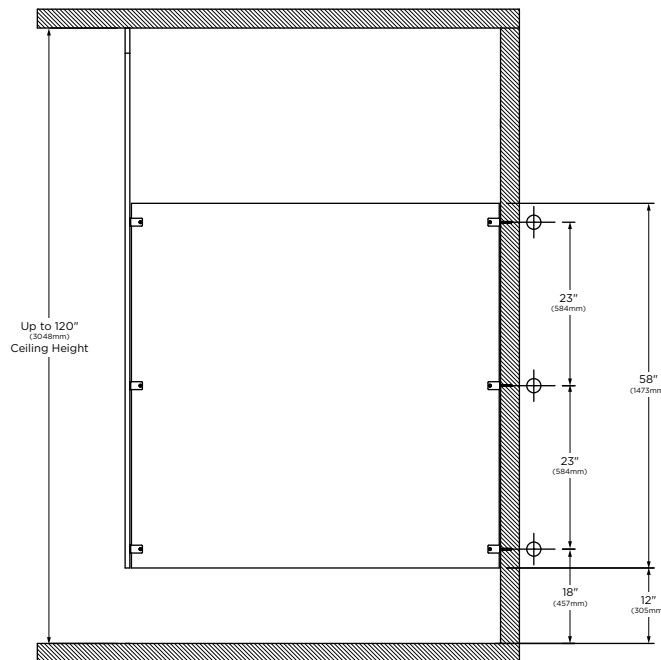

**CEILING-HUNG URINAL SCREEN**

**STANDARD:**

- #1558 - Standard Bracket

**INSTALLATION:**

Refer to Bobrick installation instructions packed with each shipment. Also available on bobrick.com. Form No. 1550-69.

**NOTES:**

1. Where water from showers or hose-down cleaning comes in contact with partitions, Bobrick 1080 Series water-resistant, solid phenolic partitions are recommended.
2. Ceiling-hung partitions require structural members (not furnished by Bobrick) in ceiling. For suggested types of ceiling support systems, see Bobrick Advisory Bulletin TB-32.
3. Wall backing is required to secure the mounting brackets of panels, stiles, and wall posts. For suggested wall backing, see Bobrick Advisory Bulletin TB-46.
4. Floor-anchored stiles are furnished with expansion anchors and threaded rods. The expansion anchors require minimum 2" (50mm) penetration into minimum 3" (75mm) thick structural concrete.
5. Bobrick stainless steel partition-mounted washroom accessories are available for mounting in panels between two compartments. See current Bobrick Catalog for description of accessories. Cutouts in panels can be pre-cut for Bobrick models at factory if location and size of all cutouts and Bobrick model numbers are furnished at time of order.
6. When the cam has been set at the desired free resting position, "either closed or open" the top of the affixed components will be aligned.

**GUARANTEE:**

The Bobrick toilet partition panels, doors and stiles are warranted for a period of 2 years against breakage, corrosion, delaminating and defects in workmanship from the date of purchase for the periods set forth (this limited warranty is conditioned on the toilet partitions being properly installed, used and serviced). Spraying down or hosing HPL partitions voids warranty. Any products returned to Bobrick under this guarantee will be repaired or replaced at no charge.

**SPECIFICATION:**

High pressure laminate (HPL) \_\_\_\_\_ (insert one product application: toilet partition, dressing compartment or urinal screen) shall be \_\_\_\_\_ (insert one series: floor-anchored, overhead-braced, wall-hung urinal screens or ceiling-hung). Stiles, panels, and doors shall have a finished thickness of 1" (25mm). Core of panels, doors, and stiles shall be 3-ply, 45-lb (20.4-kg) density, resin-impregnated particle board. Stiles shall have a one-piece, Type-304, satin-finish stainless steel shoe that is 4" (102mm) high. Surfaces and edges shall be .050" (1.3mm) thick, high-pressure laminate with colored face sheets and matte finish; 1 bonding shall be done using adhesives especially formulated to prevent delamination from moisture and heat normally existing in public washrooms. Stiles, panels, and doors shall be \_\_\_\_\_ (insert color name and number from current Bobrick Toilet Partition Catalog). Headrails for overhead-braced compartments shall be anodized aluminum with satin finish. Hinges, slide latch, door keeper and coat hook shall be stainless steel with satin finish. Stainless steel screws are furnished for all inswing and outswing doors. Mounting brackets shall be 18-8, Type-304, heavy-gauge stainless steel with satin finish. Stainless steel screws shall be furnished for all mounting brackets. Hinges shall be adjustable to hold doors of unoccupied compartments partially open or fully closed, and shall allow a locked compartment to be opened from outside by lifting door to disengage latch from keeper. Screws shall be furnished for all door hardware. Plated-steel Phillips screws shall be furnished for securing door latches.

1Non-standard colors may utilize .035" to 0.39" thick, high pressure laminate.

\_\_\_\_\_ (insert one: Toilet Partitions, Dressing Compartments, Shower Dividers, Urinal Screens, Entrance Screens) shall be \_\_\_\_\_ Series (insert series number) of Bobrick Washroom Equipment, Inc., Clifton Park, New York; Jackson, Tennessee; Los Angeles, California; Bobrick Washroom Equipment Company, Scarborough, Ontario; Bobrick Washroom Equipment Pty. Ltd., Australia; and Bobrick Washroom Equipment Limited, United Kingdom.