

# MAINTENANCE INSTRUCTIONS AND PARTS LIST FOR BOBRICK SOAP VALVES

## VALVE REPLACEMENT INSTRUCTIONS

### TO REMOVE VALVE:

1. Open filler-top by inserting BobKey (24-17) into slot of filler-top and then sliding latch to the left. Lift up filler-top.
2. Loosen locking-screw inside dispenser. Remove dispenser from wall and empty soap container.
3. Place 1" (25mm) closed-end wrench (provided) inside soap container and over the large collar nut at rear of soap valve and loosen until face of valve can rotate.
4. While holding the collar nut in place with the wrench, unscrew the valve from the front of the unit by rotating counterclockwise.

### TO INSTALL VALVE:

#### A. On Units With Notched Hole in Container

1. Hold the collar nut with the 1" (25mm) closed-end wrench. Make sure the notch in the collar nut is facing toward the front of the dispenser and position nut behind soap valve hole inside dispenser.
2. Screw new soap valve into collar nut, clockwise, until rear of valve face hits the front of the soap container.
3. Push the soap valve into the soap container with valve tabs in the soap valve hole notches with spout facing downward.
4. Tighten collar nut with wrench until tight enough so that valve will not leak around seal at front of unit.
5. Install soap dispenser on wall bracket.

#### B. On Units With Round Hole in Soap Container

1. Pull back flat rubber washer at rear of soap valve face to expose the two plastic tabs.
2. Cut plastic tabs off rear of soap valve face flush with indicated surface.
3. Move flat rubber washer back to its initial position. Make sure flat edge of washer is even with the top of valve face.
4. Hold the collar nut with the 1" (25mm) closed-end wrench. Make sure the notch in the collar nut is facing toward the front of the dispenser and position nut behind soap valve hole inside dispenser.
5. Screw new soap valve into collar nut, clockwise, until rear of valve face hits the front of the soap container. Adjust so that spout faces downward.
6. Tighten collar nut with wrench until tight enough so that valve will not leak around seal at front of unit.
7. Install soap dispenser on wall bracket.

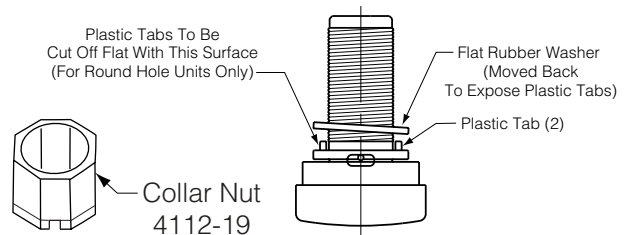

## SUREFLO VALVE 2111-79 (use in pre-1994)

**MAINTENANCE:** Use soaps free of dirt, abrasives, chips, or other foreign matter. Keep soap and dirt from clogging spout, piston, and/or guide assemblies. Clean spout with BobKey and/or remove piston assembly and soak in hot water. If valve continues to operate unsatisfactorily after following the maintenance procedures, replace any defective O-rings and/or capsule valve assembly (Part No. 190-23)

### CAUTION: DO NOT USE SOAPS CONTAINING IODOPHORS.

#### To Disassemble Valve:

1. Use hex-wrench part of the BobKey (24-17) provided to unscrew the spout (2111-24).
2. Withdraw the piston assembly (2111-38) and washer (2111-21).
3. Withdraw the guide assembly (2111-20).
4. Remove the spring (2111-106) and the spring housing (2111-26).
5. Remove the capsule valve assembly (190-23).

#### To Assemble Valve:

**Note:** It is important to wet all parts either with soap or water and assemble them wet.

Valve may not prime if all the parts are completely dry.

1. Place the capsule valve assembly (190-23) in its cavity at the back of the spring housing (2111-26) with the small hole of its washer showing face up.
2. Insert the spring (2111-106) so its large end is to the bottom of the spring housing well.
3. Insert the spring housing into the cylinder, making sure the small hole of the capsule valve assembly is centered and visible through the cylinder hole. The capsule valve must sit flat in this position during the remaining assembly procedures.
4. Insert the guide assembly (2111-20) into the cylinder. Make sure the O-rings are not torn or dented; if they are, replace the guide assembly. Align the hole in guide assembly with the hole in the side of cylinder.
5. Inspect the piston assembly O-rings. If they are torn or dented, then replace the piston assembly.
6. Place the washer (2111-21) on the duckbill end of piston assembly (2111-38).
7. Align slot in piston assembly with hole in the side of cylinder, then insert piston assembly with washer. Make sure O-rings are inserted without damage.
8. Assemble spout (2111-24) and thread it into the hole in the side of cylinder. Spout will not thread if hole in guide assembly and slot in piston assembly are not also aligned.
9. Replace outside O-ring (12-22) if needed.

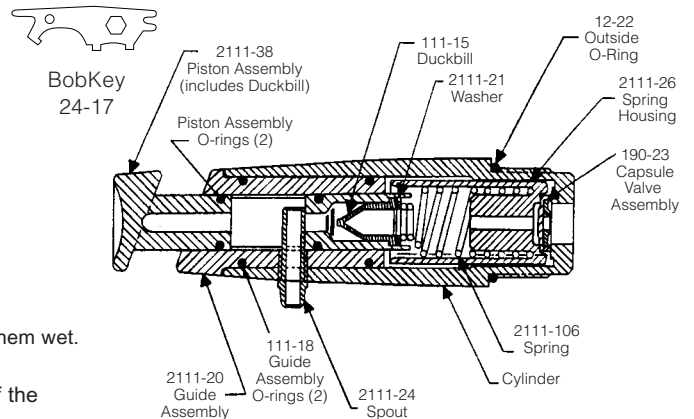

# MAINTENANCE INSTRUCTIONS AND PARTS LIST FOR BOBRICK SOAP VALVES

## ALL-PURPOSE VALVE 306-476(earlier series use 2111-79)

**MAINTENANCE:** Use soaps free of dirt, abrasives, chips, or other foreign matter. Keep soap and dirt from clogging spout, piston, and/or guide assemblies. Clean spout with BobKey and/or remove piston assembly and soak in hot water. If valve continues to operate unsatisfactorily after following the maintenance procedures, replace any defective O-rings and/or capsule valve assembly (Part No. 190-23)

**CAUTION: DO NOT USE SOAPS CONTAINING IODOPHORS.**

### To Disassemble Valve:

1. Use hex-wrench part of the BobKey (24-17) provided to unscrew the spout (2111-24).
2. Withdraw the piston assembly (2111-38) and washer (2111-21).
3. Withdraw the guide assembly (2111-20).
4. Remove the spring (2111-106) and the spring housing (2111-26).
5. Remove the capsule valve assembly (190-23).

### To Assemble Valve:

**Note:** It is important to wet all parts either with soap or water and assemble them wet.

Valve may not prime if all the parts are completely dry.

1. Place the capsule valve assembly (190-23) in its cavity at the back of the spring housing (2111-26) with the small hole of its washer showing face up.
2. Insert the spring (2111-106) so its large end is to the bottom of the spring housing well.
3. Insert the spring housing into the cylinder, making sure the small hole of the capsule valve assembly is centered and visible through the cylinder hole. The capsule valve must sit flat in this position during the remaining assembly procedures.
4. Insert the guide assembly (2111-20) into the cylinder. Make sure the O-rings are not torn or dented; if they are, replace the guide assembly. Align the hole in guide assembly with the hole in the side of cylinder.
5. Inspect the piston assembly O-rings. If they are torn or dented, then replace the piston assembly.
6. Place the washer (2111-21) on the duckbill end of piston assembly (2111-38).
7. Align slot in piston assembly with hole in the side of cylinder, then insert piston assembly with washer. Make sure O-rings are inserted without damage.
8. Assemble spout (2111-24) and thread it into the hole in the side of cylinder. Spout will not thread if hole in guide assembly and slot in piston assembly are not also aligned.
9. Replace outside O-ring (306-42), or Spacer (306-33) if needed.

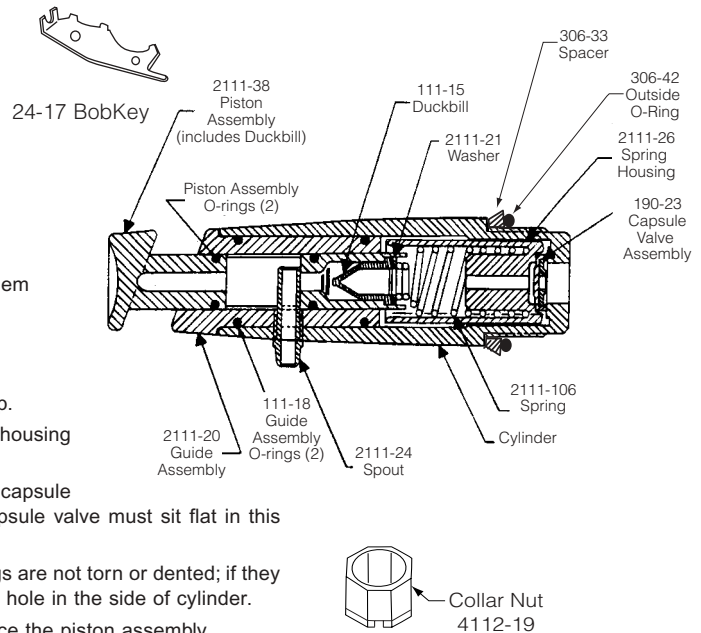

## LATHER VALVE ASSEMBLY 47-89

**MAINTENANCE:** Keep soap and dirt from clogging spout, plunger and valve mechanism. Clean spout with BobKey and/or remove plunger and valve mechanism and soak in hot water. If, after long use, lather valve (47-89) begins to drip, replace O-rings. Bobrick repair kit for lather soap valves may be ordered separately (Part No. 47-99). These kits contain O-rings, springs, and other repair parts to service six (6) valves.

**CAUTION: DO NOT USE SYNTHETIC DETERGENTS, LOTIONIZED SOAPS, OR ANTISEPTIC SOAPS.** Lather valves, in order to operate properly, must be free of lotions and creams. Use only clear coconut-oil liquid hand soap diluted to 10-15% concentration.

### TO DISASSEMBLE LATHER VALVE:

1. Remove guide screw (47-106) with BobKey (24-17).
2. Pull out plunger assembly (47-50).
3. Grip soap piston (47-106) with needle-nosed pliers and pull valve mechanism (47-85) out of cylinder (47-91).

### TO ASSEMBLE LATHER VALVE:

1. Place O-ring for needle valve (861-14) over cylinder hole with pointed object such as pencil.
2. Place retainer (860-11) over O-ring (861-14).
3. Push valve mechanism (47-85) into cylinder (47-91). Make sure needle valve passes through both retainer and O-ring.
4. Push plunger assembly (47-50) into cylinder with groove in plunger facing down to align with threaded hole in cylinder for guide screw (47-106).
5. Tighten guide screw (47-106) with BobKey (24-17).

