

Information and Troubleshooting for the InstaDry™ B-7125 High-Speed Hand Dryer

For complete set of Installation Instructions refer to form No. 7125-69

Information about the Dryer:

- Surface-Mounted, ADA compliant.
- Durable, satin-finish stainless steel cover.
- High-speed hand drying in less than 12 seconds.
- Energy efficient operation, only 200 Watt energy consumption.

Product Type:

B-7125

Universal voltage, one model works for 110-240V.

Electrical Characteristics

110V-240V, 0.8-1.9 AMP, 50/60 Hz, 202-213 Watts, cULus and CE marked.

Removal of Cover

1. Remove two screws, from the bottom of the dryer. Rotate the bottom of the cover forward about 30°, then lift the cover from the mounting base.

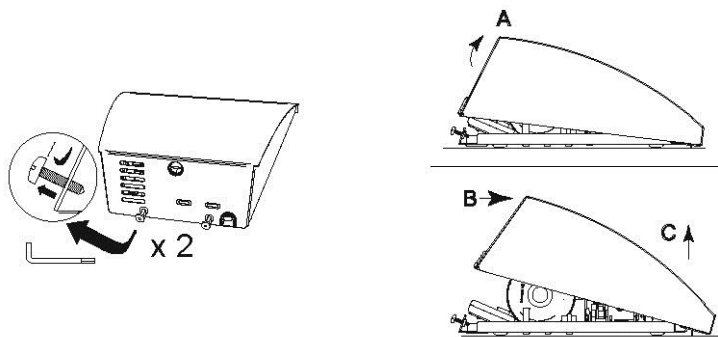

Warning
Risk of electric
shock



Disconnect power
supply before
removing cover

If a fault occurs with the dryer:

1. Check that the electrical supply is working properly.
2. Check that the circuit breaker is switched on.
3. Clean the sensor lens.

Replacement Parts

7125-150 Dryer Cover

7125-25 Control (Universal)

7125-30 Control Loom (Wiring)

Diagnostic Sheet for InstaDry™ B-7125 High-Speed Hand Dryer

<u>Problem</u>	<u>Possible Cause</u>	<u>Possible Solution</u>
Dryer doesn't run	No electricity supply	Check main supply/wiring
	Dirty controller lens	Clean controller lens
	Installation fault	Check circuit diagram label for possible wiring mistakes
	Controller faulty	Replace controller
	Faulty power supply	Return dryer to Bobrick for repair
	Faulty motor/blower	Return dryer to Bobrick for repair
	Faulty controller loom (wiring)	Replace controller loom
Dryer runs at low speed	Excessive dust build up	Follow internal cleaning procedure
	Controller faulty	Replace controller
	Faulty power supply	Check main supply/wiring
	Faulty blower motor	Return dryer to Bobrick for repair
Dryer runs continuously	Controller faulty	Replace controller
	Faulty blower motor	Return dryer to Bobrick for repair
	Faulty controller loom (wiring)	Replace controller loom
Dryer turns on randomly and/or cycles on and off	Controller faulty	Replace controller
	Dryer too close to sink top or other surface	Reinstall dryer in appropriate or location
	Dryer subject to strong sunlight or artificial light	Reinstall dryer in appropriate location
Dryer unresponsive to hands or runs inconsistently	Dirty controller lens	Clean controller lens
	Controller faulty	Replace controller
Dryer is oversensitive	Controller faulty	Replace controller
Excessive noise	Worn motor/blower	Return dryer to Bobrick for repair

Schematic Diagram

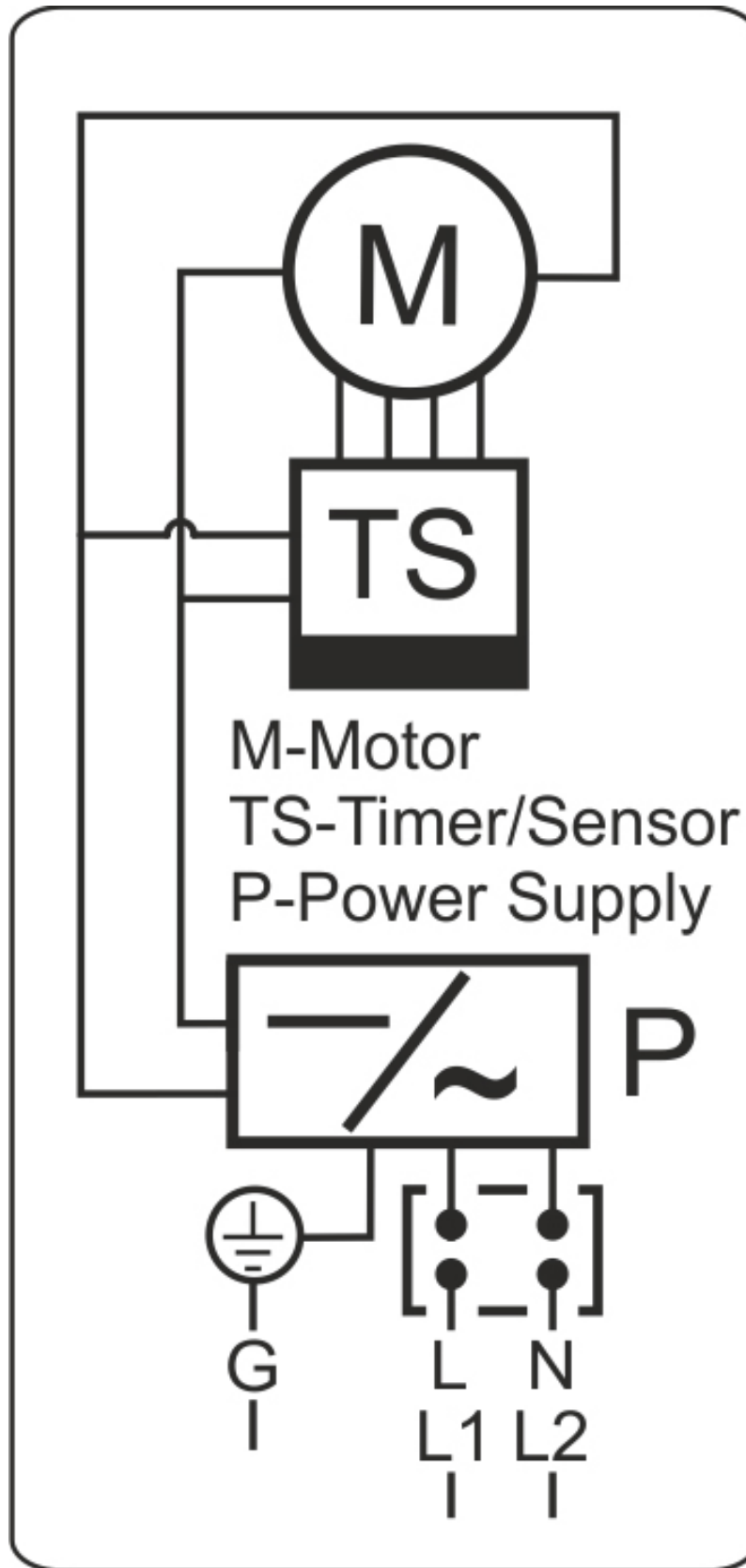

Limited Warranty

The Bobrick B-7125 InstaDry Dryer of the serial number(s) indicated herein, and all parts are warranted to the original owner of the installed unit for five years from date of original purchase against defects in factory workmanship or material under normal use and service*.

This warranty is limited to repair or exchange of defective parts at the option of Bobrick

THIS WARRANTY DOES NOT COVER ACCIDENTAL DAMAGE, IMPROPER HANDLING OR INSTALLATION, OR REPAIRS MADE BY UNAUTHORIZED PERSONS, AND SPECIFICALLY EXCLUDES CLAIMS FOR INDIRECT, ACCIDENTAL OR CONSEQUENTIAL DAMAGES TO PROPERTY. THE IMPLIED WARRANTIES OF MERCHANTABILITY AND FITNESS FOR A PARTICULAR PURPOSE ARE LIMITED TO THE SAME DURATION OF THE ABOVE WARRANTY.

Some states do not allow the exclusion of incidental or consequential damages, so the above limitation or exclusion may not apply to you. Some states do not allow limitations on how long an implied warranty lasts, so the above limitation may not apply to you. This warranty gives you specific legal rights, and you may also have other rights which vary from state to state.

*** Normal service constitutes performing the following preventive maintenance procedures at six-month intervals:**

Clean any lint, dust or grease from air-intake grille and air-outlet grille.

Labor costs for preventive maintenance shall be at owner's expense.

For repair or exchange of defective part, send the part together with installation date and serial number to Bobrick.